

Polarization Maintaining Band Pass Filter

Features	
Low Insertion Loss	
High Isolation	
High Stability and reliability	
Application	
Communication systems	

Specifications

Parameters	Value	
Nominal Center Wavelength (nm)	1064	
Wavelength Range (nm)	1064±1	1064±2.5
Insertion Loss (dB)	≤1.2	≤0.8
Pass Bandwidth @0.5dB (nm)	2	5
Stop Bandwidth @25dB (nm)	10	22
Isolation (dB)	≥30@1000~1050&1080~1100 nm	≥25@1000~1055&1075~1100 nm
ER, 23°C (dB)	≥20	
Optical Return Loss (dB)	≥50	
Optical Power(CW) (mW)	≤300	
Tensile Load (N)	5	
Fiber Type	PM 980 Panda Fiber	
Operating Temperature (°C)	-5 to +70	
Storage Temperature (°C)	-40 to +85	
Package Dimension (mm)	φ5.5×L35(P1)	

*Above specifications are for devices without the connectors.

*For devices with connectors, IL will be 0.3dB higher, RL will be 5dB lower, and ER will be 2dB lower.

*The PM fiber and the connector key are aligned to the slow axis.

Package Dimensions

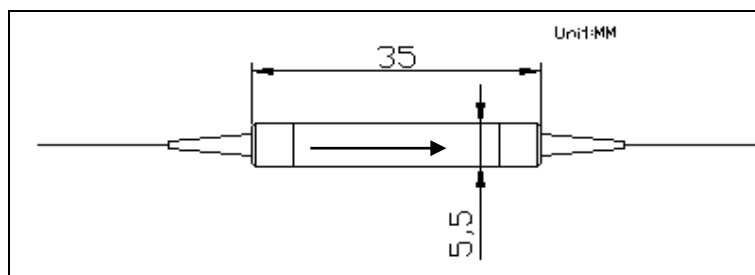

Ordering Information

PMBPF	Wavelength	Pass Width	Band	Stop Band Width	Fiber Pigtail	Length	Connector
	1064=1064nm	2=2 nm 5=5nm		10=10nm 22=22nm	1=250um bare fiber 2=900um loose tube 3=3mm loose tube 4=2mm loose tube	H=0.5m 8=0.8m 1=1.0m 5=1.5m 2=2.0m 3=3.0m 4=4.0m A=2.5m B=5.0m	0=None 1=FC/UPC 2=FC/APC 3=LC/UPC 4=LC/APC 5=SC/APC 6=SC/UPC